

aiwa

Compact Disc Stereo System

XR-M131

COMPACT
disc
DIGITAL AUDIO

U C

For assistance and information

call toll free 1-800-BUY-AIWA

(United States and Puerto Rico)

8B-CLB-903-31
010620DYK-H-B

OPERATING INSTRUCTIONS

En (English)

MANUAL DE INSTRUCCIONES

E (Español)

MODE D'EMPLOI

F (Français)

PRECAUTIONS

WARNING

To reduce the risk of fire or electric shock, do not expose this appliance to rain or moisture.

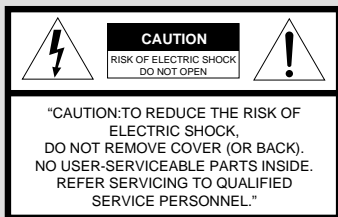

Explanation of Graphical Symbols:



The lightning flash with arrowhead symbol, within an equilateral triangle, is intended to alert the user to the presence of uninsulated "dangerous voltage" within the product's enclosure that may be of sufficient magnitude to constitute a risk of electric shock to persons.



The exclamation point within an equilateral triangle is intended to alert the user to the presence of important operating and maintenance (servicing) instructions in the literature accompanying the appliance.

Read these Operating Instructions carefully and completely before operating the unit. All precautions in this booklet and on the unit should be strictly followed.

Keep the Operating Instructions for future reference.

Installation

1 Water and moisture — Do not use this unit near water, such as near a bathtub, washbowl, swimming pool, or the like.

2 Heat — Do not use this unit near sources of heat, including heating vents, stoves, or other appliances that generate heat. It also should not be placed in temperatures less than 5°C (41°F) or greater than 35°C (95°F).

3 Mounting surface — Place the unit on a flat, even surface.

4 Ventilation — The unit should be situated with adequate space around it so that proper heat ventilation is assured. Allow 10 cm (4 in.) clearance from the rear and the top of the unit, and 5 cm (2 in.) from each side.

- Do not place the unit on a bed, rug, or similar surface that may block the ventilation openings.
- Do not install the unit in a bookcase, cabinet, or airtight rack where ventilation may be impeded.

5 Objects and liquid entry — Make sure that objects or liquids do not get inside the unit through the ventilation openings.

6 Carts and stands — When placed or mounted on a stand or cart, the unit should be moved with care. Quick stops, excessive force, and uneven surfaces may cause the unit or cart to overturn or fall.



7 Condensation — Moisture may form on the CD pickup lens when:

- The unit is moved from a cold spot to a warm spot
- The heating system has just been turned on
- The unit is used in a very humid room
- The unit is cooled by an air conditioner

When this unit has condensation inside, it may not function normally. Should this occur, leave the unit for a few hours, then try to operate again.

8 Wall or ceiling mounting — The unit should not be mounted on a wall or ceiling, unless specified in the Operating Instructions.

Electric Power

1 Power sources — Connect this unit only to power sources specified in the Operating Instructions, and as marked on the unit.

2 Polarization — As a safety feature, some units are equipped with polarized AC power plugs which can only be inserted one way into a power outlet. If it is difficult or impossible to insert the AC power plug into an outlet, turn the plug over and try again. If it still does not easily insert into the outlet, please call a qualified service technician to service or replace the outlet. To avoid defeating the safety feature of the polarized plug, do not force it into a power outlet.

3 AC power cord

- When disconnecting the AC power cord, pull it out by the AC power plug. Do not pull the cord itself.
- Never handle the AC power plug with wet hands, as this could result in fire or shock.
- Power cords should be firmly secured to avoid being severely bent, pinched, or walked upon. Pay particular attention to the cord from the unit to the AC outlet.
- Avoid overloading AC outlets and extension cords beyond their capacity, as this could result in fire or shock.

4 Extension cord — To help prevent electric shock, do not use a polarized AC power plug with an extension cord, receptacle, or other outlet unless the polarized plug can be completely inserted to prevent exposure of the blades of the plug.

5 When not in use — Unplug the AC power cord from the AC outlet if the unit will not be used for several months or more. When the cord is plugged in, a small amount of current continues to flow to the unit, even when the power is turned off.

Outdoor Antenna

1 Power lines — When connecting an outdoor antenna, make sure it is located away from power lines.

2 Outdoor antenna grounding — Be sure the antenna system is properly grounded to provide protection against unexpected voltage surges or static electricity build-up. Article 810 of the National Electrical Code, ANSI/NFPA 70, provides information on proper grounding of the mast, supporting structure, and the lead-in wire to the antenna discharge unit, as well as the size of the grounding unit, connection to grounding terminals, and requirements for grounding terminals themselves.

Antenna Grounding According to the National Electrical Code

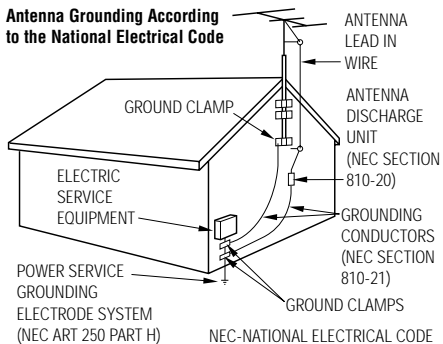

Maintenance

Clean the unit only as recommended in the Operating Instructions.

Damage Requiring Service

Have the unit serviced by a qualified service technician if:

- The AC power cord or plug has been damaged
- Foreign objects or liquid have gotten inside the unit
- The unit has been exposed to rain or water
- The unit does not seem to operate normally
- The unit exhibits a marked change in performance
- The unit has been dropped, or the cabinet has been damaged

DO NOT ATTEMPT TO SERVICE THE UNIT YOURSELF.

TABLE OF CONTENTS

PRECAUTIONS	2
PREPARATIONS	4
PARTS AND CONTROLS	5
ADJUSTMENTS BEFORE OPERATION	7
CD OPERATIONS	8
RADIO OPERATIONS	10
TAPE OPERATIONS	11
TIMER OPERATIONS	14
REFERENCE	16

System and accessories

Main unit

Speakers

Remote control

FM antenna

AM antenna

OWNER'S RECORD

Record the model number and serial number of your set (found at the rear of your set) below. Refer to them when contacting your Aiwa dealer.

Model No. _____

Serial No. _____

PREPARATIONS

Connection

Plug in the AC power cord to the AC power outlet after all other connections are made.

1 Connect the speakers.

Connect the right speaker to the SPEAKERS R terminals and the left to the SPEAKERS L terminals. The speaker cords with the stripes go to the \oplus terminals.

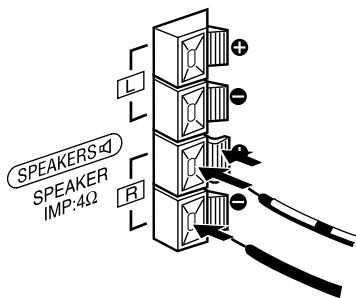

2 Connect the supplied antennas.

Connect the FM antenna to the FM 75 Ω terminals and the AM antenna to the AM LOOP terminals.

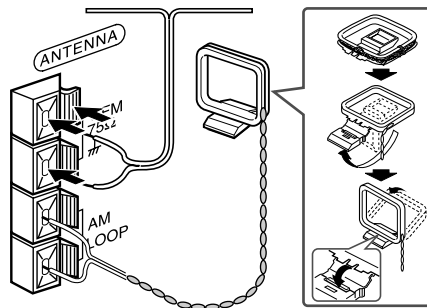

3 Connect the AC power cord to an AC outlet.

The clock will flash on the display.
For setting the clock, see page 8.

Speakers

- Do not short-circuit the \oplus and \ominus speaker cord leads.
- Do not leave objects generating magnetism or objects affected by magnetism near the speakers.

Antennas

Keep antennas away from metallic objects, electrical equipment and cords.

- **FM antenna:** Extend fully in a T-shape. If reception is poor, connect an optional outdoor antenna to the FM 75 Ω terminals. Be sure to connect the shield braid of the antenna to the ⚡ terminal.
- **AM antenna:** Rotate to find best reception.

Remote control

Detach the battery compartment lid at the rear of the remote control and insert two R6 (size AA) batteries with correct polarity.

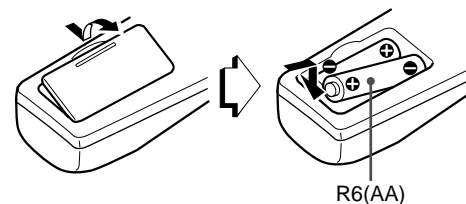

- Replace the batteries with new ones when the operational distance between the remote control and main unit becomes shorter.
- Remove the batteries if the unit is not going to be used for an extended period of time.
- The remote control may not operate if it is used under intense sunlight, etc., or if its line of sight is obstructed.

PARTS AND CONTROLS

Main unit: front

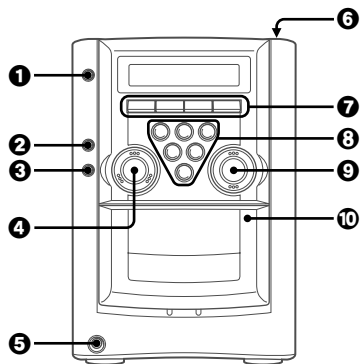

1 POWER \odot STANDBY/ON

Switches the unit on and off (standby).

2 QSOUND

Turns QSOUND on or off.

3 TIMER/SLEEP

Selects timer setting mode.

4 3-MODE EQUALIZER

Selects a sound equalization curve, ROCK, POP or JAZZ.

5 PHONES jack

Plug in optional headphones set with a stereo mini plug ($\varnothing 3.5$ mm, $1/8$ in.). Speaker output is canceled.

6 CD OPEN

Opens or closes the disc compartment.

7 TAPE

Selects Tape function.

TUNER/BAND

Selects Radio function and the radio band.

AUX

Selects the function of external equipment connected to AUX jacks.

CD

Selects CD function.

8 IISET

CD and Tape: pauses playback.

Radio: stores the received station to preset.

▶ PRESET

CD and Tape: starts playback.

Radio: tunes in a preset station.

■ CLEAR

CD and Tape: stops playback.

Radio: clears a station preset.

◀◀/I◀, ▶▶/I▶▶ (TUNING DOWN, UP)

CD: skips to a previous or a succeeding track when pressed, searches a track in fast forward or reverse playback when held down.

Tape: rewinds or fast forwards the tape.

Radio: manually tunes up or down within the band.

● REC/REC MUTE

Starts recording.

REC MUTE: also used to enter 4-second blank spaces.

9 VOLUME UP/DOWN

Adjusts the volume.

10 ▲ PUSH EJECT

Opens or closes the cassette holder.

Remote control

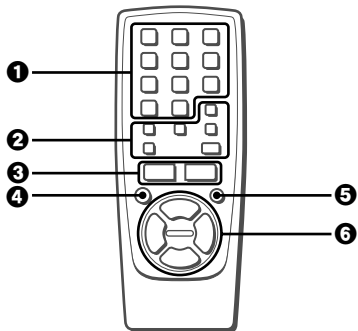

Buttons with the same or similar names on the main unit basically have the same function.

❶ 0–9, +10

CD: selects a track of the specified number.

Radio: tunes in the station with the specified preset number.

❷ REPEAT

Selects CD repeat playback mode.

DISPLAY

Displays the time or the adjusted volume level.

EQ

Selects a sound equalization curve; ROCK, POP, JAZZ or EQ OFF.

MODE

Selects random play, programmed play, AI edit recording or programmed edit recording mode for CD playback or recording.

BAND

Selects Radio function and the radio band.

FUNCTION

Switches the active function among TAPE, FM/AM, AUX and CD.

❸ VOL (▼/▲)

❹ POWER

❺ PAUSE

❻ PLAY

◀◀/▶▶, ▶▶/▶▶ (SKIP/SEARCH)

■ STOP

Main unit: rear

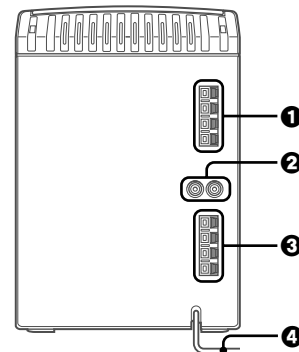

❶ AM LOOP and FM 75 Ω terminals

Plug in the supplied AM and FM antennas.

❷ AUX jacks

Accept analog sound signals from external equipment. Connect external equipment using an optional connecting cable with RCA phono plugs (red plug to R jack, white plug to L jack). Refer also to the operating instructions for your equipment.

To switch function to external input, press AUX.

❸ SPEAKERS terminals

Connect the speaker cords of the supplied speakers.

❹ AC power cord

ADJUSTMENTS BEFORE OPERATION

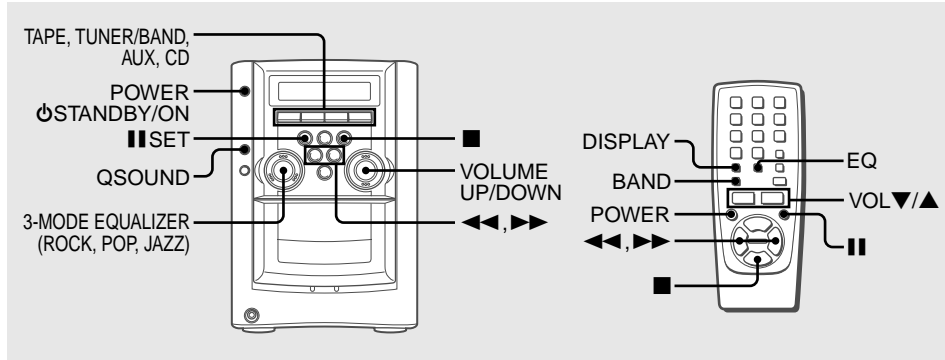

Power

Turning the unit on

Press POWER STANDBY/ON (POWER on the remote control).

Alternatively, press TAPE, TUNER/BAND (BAND on the remote control), AUX or CD. Playback will start automatically if a disc or tape is loaded.

Turning the unit off

Press POWER STANDBY/ON again. The unit goes into standby.

Volume

Press VOLUME DOWN or UP (VOL ▼/▲ on the remote control).

Adjust from 0 (minimum) to 30 and MAX (maximum).

Pressing DISPLAY twice displays the adjusted volume level.

Tip:

Volume level setting is retained during power-off standby. If the unit is turned off with the volume set to 21 or more, it is automatically turned down to 20 the next time the unit is turned on.

Graphic equalizer

Selects a sound equalization curve to match the music type.

Press 3-MODE EQUALIZER (ROCK, POP, JAZZ) (EQ on the remote control repeatedly) to select one of the three equalization curves.

- ROCK: Powerful sound emphasizing treble and bass
- POP: More presence in the vocals and midrange
- JAZZ: Accented lower frequencies for jazz-type music

To cancel equalization

Press the selected equalization mode button (EQ on the remote control repeatedly).

"EQ OFF" is displayed.

Q SOUND system

The Q SOUND system creates a wider sound area by processing the original music signals electronically.

Press QSOUND.

"Q SOUND" is displayed.

To cancel the Q SOUND

Press QSOUND so that "Q SOUND" disappears from the display.

Tip:

When the QSOUND system is activated, the sound may be distorted. If this happens, decrease the volume.

Setting the clock

- 1 Press **||** on the main unit while the power is off. The hour flashes.
- 2 Press **<<** or **>>** to designate the hour.
- 3 Press **||**. The hour stops flashing and the minute starts flashing.
- 4 Press **<<** or **>>** to designate the minute.
- 5 Press **||**. The time display stops flashing and the clock starts from 00 seconds.

To display the time while the power is on.

Press DISPLAY on the remote control. The time will be displayed for 4 seconds, but it cannot be displayed during recording.

To switch to the 24-hour standard

While the time is displayed, press **■**. With each press, the clock alternates between the 12- and 24-hour standard time.

Tip:

In the 12-hour standard, "AM 12:00" indicates midnight and "PM 12:00" noon.

If the clock display flashes when the unit is turned off

There has been a power interruption. Reset the clock.

CD OPERATIONS

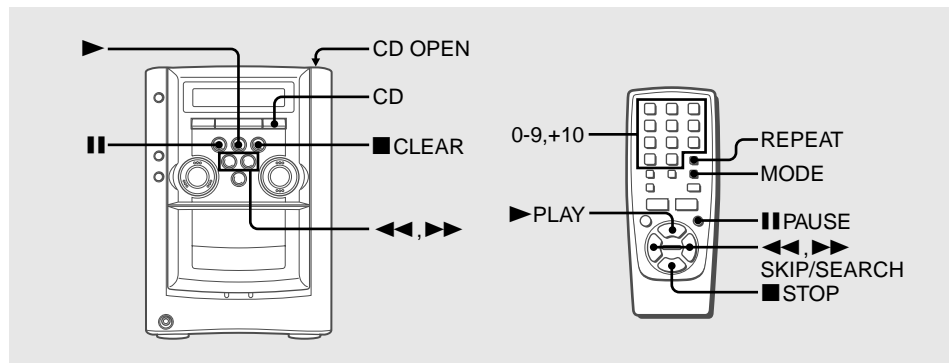

This unit plays back finalized CD-R/RW discs as well as audio CDs.

Playback

- 1 Press CD.
- 2 Press CD OPEN to open the disc compartment. Place a disc with the label side up. Then close the disc compartment.
- 3 Press **▶** to start play.

To stop playback

Press **■**.

To pause playback

Press **||**. Press again to resume playback.

To skip to the beginning of the current/preceding/succeeding track

Press **<<** or **>>** repeatedly.

To search (playback in fast forward or reverse)

Hold down **<<** or **>>**. Release at the desired point.

To select a track with the remote control (Direct play)

- Press the numbered buttons to select a track.
- To select the 25th track, press +10, +10 and 5.
 - To select the 10th track, press +10 and 0.

Random/Repeat playback

Random playback plays all the tracks in random order. Repeat playback plays all the tracks or the track being played repeatedly. You can select random and repeat all playback at the same time.

Random play

- 1 Press MODE on the remote control once in stop mode. "RAN" is displayed.
- 2 Press **▶** to start play.

To cancel, press MODE repeatedly or **■** in stop mode so that "RAN" disappears.

- Direct selection of the tracks with the numbered buttons cancels the random play mode.

Repeat play

Press REPEAT on the remote control repeatedly to select "REPEAT ALL" or "REPEAT 1".

To cancel, press REPEAT repeatedly so that the repeat indicator goes off.

To repeat a selected set of tracks

Select the tracks with programmed playback, then press REPEAT on the remote control to select repeat playback. (See "Programmed playback" on this page.)

- If the random play mode is activated during "REPEAT 1" play mode, the "REPEAT 1" will be canceled and "REPEAT ALL" will be selected instead.

Programmed playback

Plays back up to 30 selected tracks in programmed order.

- 1** Press MODE on the remote control twice in stop mode.

"M" flashes on the display.

- 2** Press the numbered buttons on the remote control to program a track.

-To select the 25th track, press +10, +10 and 5.

-To select the 10th track, press +10 and 0.

The selected track number lights up on the display.

- 3** Repeat step 2 to program other tracks.

The total number of selected tracks and total playing time will be displayed.

- 4** Press ►.

The track number for the current track flashes on the display.

- During programmed playback, you cannot
-select repeat 1 play or random play.
-select a track with the numbered buttons.
- If the total playback time of the program exceeds 99 minutes and 59 seconds, or if a track with a track number exceeding 30 is programmed, the playing time is displayed as "- :- -".

To check the program

Press ◀◀ or ▶▶ repeatedly in stop mode. The track number and program number are displayed in succession.

To clear the program

Press ■ in stop mode.

To add tracks to the program

Repeat step 2 before starting playback. The tracks are added to the end of the program.

To change the programmed tracks

Clear the program and repeat all the steps again.

Notes on CDs

- Do not place more than one disc.
- Do not tilt the unit with a disc loaded.
- The unit may not play CD-R/RW discs recorded on personal computers or certain kinds of CD-R/RW recorders.
- Do not attach adhesive labels, etc. to either side of CD-R/RW discs, as doing so may cause malfunction.
- Do not load an unrecorded CD-R/RW disc. The disc may be damaged.
- Do not use irregular-shaped CDs.
- Do not try to open the disc compartment during play.
- Do not touch the CD pickup lens. If it is soiled, a CD may not be played normally.

RADIO OPERATIONS

En

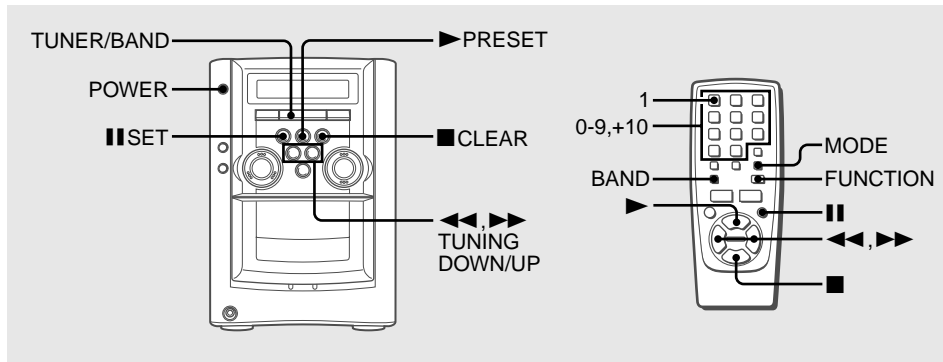

Manual tuning

- 1 Press TUNER/BAND (BAND on the remote control) repeatedly to select a band.

The unit switches to the radio from any other function and alternates between FM and AM.

- 2 Press ◀◀ or ▶▶ repeatedly to tune in a station. "TUNE" is displayed when a station is tuned in. "STEREO" is displayed for FM stereo reception.

To search for a station automatically (Auto search)

Hold down ◀◀ or ▶▶.

The unit searches for a station and stops at reception.

To stop the search manually, press ◀◀ or ▶▶.

- Auto search may not stop at stations with weak signals.

Preset tuning

Preset up to 32 of your favorite stations and tune them in directly.

Presetting stations

- 1 Tune in the desired station.
- 2 Press ■ to store the station.
The preset number, beginning from "1" and the "M" indicator are displayed on the display.
- 3 Repeat steps 1 and 2 to preset other stations.
 - Each band can store a maximum of 16 preset stations.
 - If power is interrupted for more than approximately 12 hours, all settings stored in memory after purchase need to be reset.

Tuning in preset stations

- 1 Select the band.
- 2 Press ► repeatedly.
With each press, the station with the succeeding preset number is tuned in.

You can tune in the desired preset station directly by pressing the numbered buttons on the remote control.

- To select preset number 10, press +10 and 0.
- To select preset number 15, press +10 and 5.

To scan preset stations

Press "1" until "P-SCAN" is displayed. The preset stations are received in ascending order for 5 seconds each. To stop scanning, press ■. The preset number flashes during reception.

To clear a preset station

1 Tune in the station by preset tuning.

2 Press ■, then press ■ within 4 seconds.

Preset station numbers in the band which are higher than the cleared number decrease by one.

Adjustments

To switch to monaural FM reception

Press MODE on the remote control so that "MONO" is displayed.

To cancel, press MODE repeatedly.

Tip:

When FM stereo reception is poor, switching to monaural reduces noise.

To switch the AM tuning interval

The default setting of the AM tuning interval is 10 kHz/step. If you use this unit in an area where the frequency allocation system is 9 kHz/step, change the tuning interval. Hold down TUNER/BAND and press POWER.

Tip:

When the AM tuning interval is changed, all preset stations are cleared.

TAPE OPERATIONS

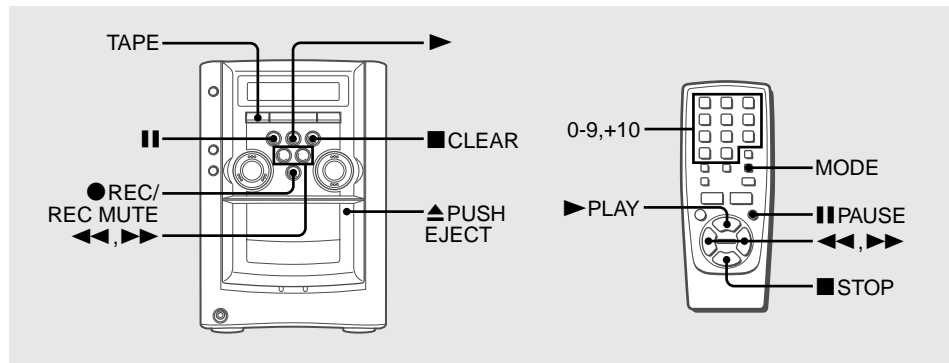

Playback

Use only type I (normal) tapes.

- 1 Press TAPE.
- 2 Press ▲ to open the cassette holder.
- 3 Insert the tape.

Insert with the exposed side down and playback side facing out from the unit.



- 4 Press ► to start play.

To stop playback

Press ■.

To pause playback

Press |||. Press again to resume.

To rewind or fast forward

Press ◀◀ or ▶▶.

To reset the tape counter

Press ■ in stop mode, and the tape counter on the display is reset to "0000".

Opening and closing the cassette holder will also reset the tape counter.

Notes on cassettes

- Use of 120-minute or longer tapes is not recommended since they are extremely thin and easily deformed or damaged.
- Wind up any slack in the tape with a pencil or similar tool before use. Slack tape may jam in the mechanism.

Basic recording

Use only type I (normal) tapes. Only one side of the tape can be recorded on at a time.

- 1 Press TAPE.
- 2 Press ▲ to open the cassette holder.
- 3 Insert the recording tape.
Insert with the exposed side down and recording side facing out from the unit.
- 4 Prepare the source.
To record CD, press CD and load a disc.
To record a radio broadcast, tune in the desired station.
To record from connected external equipment, press AUX and prepare the equipment.
- 5 Press ● to start recording.

When recording a CD, CD playback starts automatically. When recording input from connected equipment, manually start playback of the source.

- Volume or tone adjustment(s) does not affect recording.
- When the tape reaches its end, the recording stops.

To stop recording

Press ■.

To pause recording (only for TUNER or AUX source)

Press ■■. Press again to resume.

To record a selected set of tracks from a CD

Program the desired tracks (see "Programmed playback") and then press ●.

To record a 4-second blank space (only for TUNER or AUX source)

Inserting 4-second blank spaces may help you locate the beginning of the track on other equipment.

- 1 Press ● during recording or in recording pause mode.
"REC" flashes on the display for 4 seconds (a blank space is added) and then the unit enters recording pause mode.
- 2 Press ■■ to resume recording.

To record a blank space shorter than 4 seconds, press ● again while "REC" flashes.

To record a blank space longer than 4 seconds, press ● again after the unit enters recording pause mode. Each time the button is pressed, a 4-second blank space is added.

To erase a tape

- 1 Insert the tape. Set the tape to the desired point if needed.
- 2 Press AUX.
If optional equipment is connected to the AUX jacks, turn it off.
- 3 Press ●.

Edited CD recording

AI Edit Recording

Preparation

Prepare a tape that is longer than the CD length.

When recording a whole CD, AI Edit Recording takes the length of your tape into account and rearranges the recording order of the tracks if necessary, so that no track is cut short at the end of the side.

(AI: Artificial Intelligence)

- Recording cannot start from a point halfway in the tape.
- AI Edit Recording cannot be used with discs containing more than 30 tracks.

- 1 Insert the recording tape.
- 2 Press CD and load the disc.
- 3 Press MODE three times on the remote control in stop mode.
"AI C-00" is displayed.
- 4 Press the numbered buttons on the remote control to enter the length of the recording tape.
10 to 99 minutes can be specified.
- For a 60-minute tape press 6 and 0.
In a few seconds, the unit determines the tracks to be recorded for each side.
The recording time left for side A appears on the display.
• ◀◀ or ▶▶ can also be used to specify tape length.
- 5 Press ● to start recording on side A.
The tape is rewound to the beginning of side A and recording starts.
When recording on side A finishes, "SIDE CHA" appears on the display. Proceed step 6.

- 6 Press MODE once on the remote control.
The recording time left for side B appears on the display.
- 7 Turn over the tape and press ● to start recording on side B.

Programmed Edit Recording

As you program the CD tracks to record, Programmed Edit Recording displays the remaining recording time for each side of the tape, so you can easily select a set of desired tracks within the length of your tape.

- Recording cannot start from a point halfway in the tape.
- You cannot program more than 30 tracks.
- You cannot program a track with a track number larger than 30.

- 1 Insert the recording tape.
- 2 Press CD and load the disc.
- 3 Press MODE four times on the remote control in stop mode.
"PRGM C-00" is displayed.
- 4 Press the numbered buttons on the remote control to enter the length of the recording tape.
10 to 99 minutes can be specified.
- For a 60-minute tape press 6 and 0.
• ◀◀ or ▶▶ can also be used to specify tape length.
- 5 Press the numbered buttons on the remote control to select the first track to be recorded on side A.
- To select the 25th track, press +10, +10 and 5.
- To select the 10th track, press +10 and 0.

6 Repeat step 5 to select the rest of the tracks for side A.

The remaining recording time of side A is displayed. You cannot select a track with a longer playing time.

7 Press MODE on the remote control to switch to side B and select the tracks for the side.

8 Press MODE on the remote control to switch back to side A and press ● to start recording on side A.

The tape is rewound to the beginning of side A and recording starts.

When recording on side A finishes, "SIDE CHA" appears on the display. Proceed to step 9.

9 Press MODE on the remote control to switch to side B, turn over the tape, and press ● to start recording on side B.

To stop recording

Press ■. Recording and CD playback stop simultaneously.

To check the program

1 Before recording, press MODE on the remote control to select side A or B.

2 Press ◀◀ or ▶▶ repeatedly. The track number and program number are displayed in succession.

To change the program of each side

Press MODE on the remote control to select side A or B, and press ■ to clear the program for the selected side. Then, select tracks again.

To clear the edit program

Press ■ twice.

To prevent accidental erasure

Break off the plastic tab of the cassette tape with a screwdriver or other pointed tool. To record on the tape again, cover the detection slot with adhesive tape.

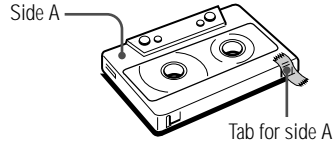

TIMER OPERATIONS

En

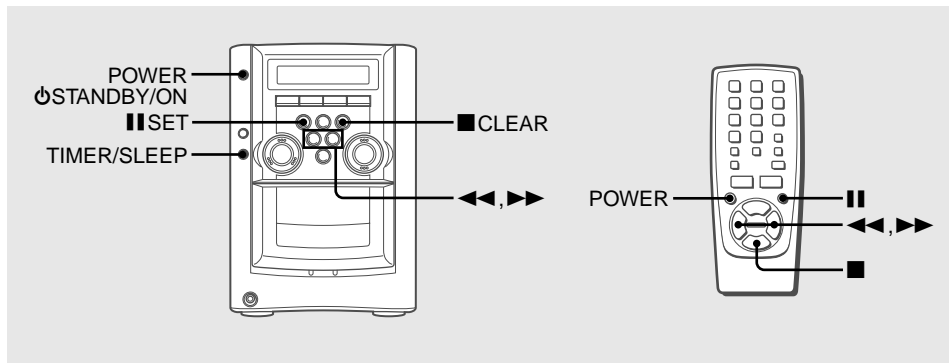

Sleep timer

Turns off the unit automatically after a specified time.

- 1 Press **TIMER/SLEEP**.
"SLEEP" is displayed.
- 2 Press **||**.
If **||** is not pressed within 4 seconds, the sleep timer setting mode is canceled.
- 3 Press **◀▶** repeatedly to set the sleep timer duration.
With each press, the timer duration changes in 5-minute steps between 5 to 240 minutes. If there is no button input for 4 seconds, the current setting is entered automatically. The unit turns off after the selected time.

To check the remaining time until the unit turns off

Press **TIMER/SLEEP**. The remaining time is displayed for 4 seconds.

To cancel the sleep timer

Press **TIMER/SLEEP** repeatedly so that "SLEEP" is displayed, then press **■** within 4 seconds.

Timer playback

Turns on the unit at a specified time for the specified duration. Make sure the clock is set correctly.

- 1 Press **TIMER/SLEEP** repeatedly so that "⌚" lights up and "TM PLAY" is displayed.
- 2 Press **||**.
If **||** is not pressed within 4 seconds, the timer setting mode is canceled.
- 3 Press **◀▶** to set the hour of the timer-on time, and press **||**.
- 4 Press **◀▶** to set the minute of the timer-on time, and press **||**.

- 5 Press **◀▶** or **▶▶** to select the source, and press **||**.
 - For timer play of a CD, select "CD".
 - For timer play of a tape, select "TAPE".
 - For timer play of a radio broadcast, select "FM" or "AM". You will select the band later in step 8.
 - For timer play of the equipment connected to the AUX jacks, select "AUX".
 - 6 Press **◀▶** or **▶▶** to set the timer-activated duration, then press **||**.
With each press, the timer-activated duration changes in 5-minute steps between 5 to 240 minutes.
 - 7 Adjust the volume and tone for timer playback.
If the volume level is set to 21 or higher, it is automatically turned down to 20 when the unit is turned on by the timer.
 - 8 Prepare the source.
 - To play CD, load a disc.
 - To play a tape, insert the tape.
 - To play the radio, select the band and tune in the desired station.
 - To play external equipment connected to the AUX jacks, set an external timer for the equipment so that its playback begins at the same time.
 - 9 Press **POWER** **⏻** **STANDBY/ON** (**POWER**) to turn the unit off.
"⌚" remains on the display to indicate the timer standby mode.
At timer-on time, the unit turns on and plays the selected source. After the specified timer-activated duration, the unit turns off again.
- Timer playback will not begin unless the unit is turned off first.
 - Connected equipment cannot be turned on or off by the built-in timer of this unit. Use an external timer.

Timer recording

Timer recording is available only for TUNER and AUX (with an external timer) sources.

- 1 Press TIMER/SLEEP repeatedly so that "⏻" lights up and "TM REC" is displayed.
- 2 Carry out step 2 to step 4 described in "Timer playback".
- 3 Press ◀◀ or ▶▶ to select the source, and press **II**.
 - For timer recording of a radio broadcast, select "FM" or "AM". You will select the band later in step 6.
 - For timer recording of the equipment connected to the AUX jacks, select "AUX".
- 4 Press ◀◀ or ▶▶ to set the timer-activated duration, then press **II**.

With each press, the timer-activated duration changes in 5-minute steps between 5 to 240 minutes.
- 5 Adjust the volume and tone for timer recording.

If the volume level is set to 21 or higher, it is automatically turned down to 20 when the unit is turned on by the timer.
- 6 Prepare the source.

To record the radio, select the band and tune in the desired station.

To record external equipment connected to the AUX jacks, set an external timer for the equipment so that its playback begins at the same time.

- 7 Insert the recording tape and then turn the unit off.

"⏻" and **REC** remain on the display to indicate the timer standby mode.

At timer-on time, the unit turns on and records the selected source. After the specified timer-activated duration, the unit turns off again.

- Connected equipment cannot be turned on or off by the built-in timer of this unit. Use an external timer.

To check the timer setting

Press TIMER/SLEEP repeatedly so that "TM PLAY" or "TM REC" appears on the display.

The timer-on time, the source and the timer-activated duration are displayed for 4 seconds.

To change the timer setting

Reset the timer again.

To cancel the timer

Press TIMER/SLEEP repeatedly until "TM OFF" is displayed.

"⏻" and **REC** disappear from the display.

Tip:

Your timer setting is retained even if the timer is canceled. Next time the timer is activated, you can change your previous setting, or simply use the same setting again.

REFERENCE

Care and maintenance

Occasional care and maintenance of the unit and the software are needed to optimize the performance of your unit.

To clean the cabinet

Use a soft and dry cloth. If the unit surfaces are extremely dirty, use a soft cloth lightly moistened with mild detergent solution. Do not use strong solvents such as alcohol, benzene or thinner.

To clean the tape heads

Dirty tape heads cause sound deterioration. After every 10 hours of use, clean the tape heads with a head cleaning cassette. Refer to the instructions of the cleaning cassette.

To demagnetize the tape heads

Use a demagnetizing cassette after every 20 to 30 hours of use. Refer to the instructions of the demagnetizing cassette.

Care of CDs

When a CD becomes dirty, wipe it from the center out with a cleaning cloth. After playing a CD, store it in its case. Do not keep it in hot or humid places.

Care of tapes

Store tapes in their cases after use. Do not leave tapes near magnets, motors, television sets, or any source of magnetism. Do not expose tapes to direct sunlight, or leave them in a car parked in direct sunlight.

Troubleshooting

If your unit fails to perform properly, check the following guide and the relevant sections of the Operating Instructions.

There is no sound

- Are the speakers and AC power cord connected properly?

The unit shut off suddenly

- Possibly a short circuit in the speaker terminals. Disconnect the AC power cord from the AC outlet and reconnect the speaker cords correctly.

Erroneous display

- Reset the unit. (See "Resetting the unit" on this page.)

Poor radio reception

- Check antenna connection. Adjust the antenna to find the best reception.
- Move the unit and antenna away from other electric appliances and cords.

The tape does not run

- Is the deck in pause?

Poor tape sound

- Check for dirty heads. Clean them if needed.
- Use type I (normal) tapes.

Cannot record

- Is the erasure prevention tab of the tape broken off? If so, cover the detection slot with adhesive tape.

The CD player works poorly

- Is the disc correctly loaded?
- Is the disc dirty?
- Is the lens affected by condensation? If so, wait approximately one hour and try again.

Resetting the unit

If an unusual condition occurs in the display window or the cassette deck, reset the unit as follows:

- 1 Press POWER to turn off the power.
If the power cannot be turned off, disconnect the AC power cord, then plug it in again.
- 2 Hold down  and press POWER.
Everything stored in memory after purchase is cleared.

Specifications

MAIN UNIT

TUNER

FM tuning range	87.5 MHz to 108 MHz
FM usable sensitivity (IHF)	13.2 dBf
FM antenna terminals	75 ohms (unbalanced)
AM tuning range	530 kHz to 1710 kHz (10 kHz step) 531 kHz to 1602 kHz (9 kHz step)
AM usable sensitivity	350 μ V/m
AM antenna	Loop antenna

AMPLIFIER

Power output	5.5 W + 5.5 W (50 Hz - 20 kHz, THD less than 1%, 4 ohms) 7 W + 7 W (1 kHz, THD 10%, 4 ohms)
Total harmonic distortion	0.2 % (2 W, 1 kHz, 4 ohms)
Input	AUX: 500 mV
Outputs	SPEAKERS: 4 ohms or more PHONES: 32 ohms or more

CASSETTE DECK

Track format	4 tracks, 2 channels stereo
Frequency response	50 Hz – 15000 Hz
Recording system	AC bias
Heads	Recording/playback \times 1, erase \times 1

CD PLAYER

Laser	Semiconductor laser ($\lambda = 780$ nm)
D/A converter	1 bit dual
Signal-to-noise ratio	85 dB (1 kHz, 0 dB)
Harmonic distortion	Unmeasurable (1 kHz, 0 dB)

GENERAL

Power requirements	120V AC, 60 Hz
Power consumption	26 W
Dimensions (W \times H \times D)	160 \times 237 \times 206 mm (6 $\frac{3}{8}$ \times 9 $\frac{3}{8}$ \times 8 $\frac{1}{8}$ in.)
Weight	2.9 kg (6 lbs 7 oz)

SPEAKER SYSTEM

Speakers	100 mm cone type
Impedance	4 ohms
Dimensions (W \times H \times D)	140 \times 232.5 \times 191.5 mm (5 $\frac{5}{8}$ \times 9 $\frac{1}{4}$ \times 7 $\frac{5}{8}$ in.)
Weight	1.1 kg (2 lbs 8 oz)

Specifications and external appearance are subject to change without notice.

COPYRIGHT

Check copyright laws relevant to recordings from discs, radio or tape for the country where the unit is to be used.

NOTE

This equipment has been tested and found to comply with the limits for a Class B digital device, pursuant to Part 15 of the FCC Rules. These limits are designed to provide reasonable protection against harmful interference in a residential installation.

This equipment generates, uses, and can radiate radio frequency energy and, if not installed and used in accordance with the instructions, may cause harmful interference to radio communications. However, there is no guarantee that interference will not occur in a particular installation. If this equipment does cause harmful interference to radio or television reception, which can be determined by turning the equipment off and on, the user is encouraged to try to correct the interference by one or more of the following measures:

- Reorient or relocate the receiving antenna.
- Increase the separation between the equipment and receiver.
- Connect the equipment into an outlet on circuit different from that to which the receiver is connected.
- Consult the dealer or an experienced radio/TV technician for help.

CAUTION

Modifications or adjustments to this product, which are not expressly approved by the manufacturer, may void the user's right or authority to operate this product.

REMARQUE

Cet appareil a été testé et jugé conforme aux limites des appareils numériques de Classe B, conformément à la Partie 15 des Règles FCC. Ces limites sont conçues pour fournir une protection raisonnable contre les interférences néfastes dans une installation résidentielle.

Cet appareil produit, utilise et peut rayonner une énergie de fréquence radio et, s'il n'est pas installé et utilisé conformément aux instructions, peut provoquer des interférences gênantes pour les communications radio. Mais rien ne garantit qu'une telle interférence ne se produira pas dans une installation particulière. Si cet appareil produit des interférences gênantes pour la réception radio ou de télévision, ce qui peut se déterminer en allumant et éteignant l'appareil, il est recommandé à l'utilisateur d'essayer de corriger cette interférence en appliquant une ou plusieurs des mesures suivantes:

- Réorientation ou déplacement de l'antenne réceptrice.
- Éloignement de l'appareil du récepteur.
- Raccordement de l'appareil à une prise d'un circuit différent de celui du récepteur.
- Consultez le revendeur ou un technicien radio/télévision expérimenté.

PRÉCAUTION

Les modifications ou ajustements de ce produit, non expressément approuvés par le fabricant, peuvent invalider le droit ou l'autorité de l'utilisateur à utiliser ce produit.

CAUTION

TO PREVENT ELECTRIC SHOCK, MATCH WIDE BLADE OF PLUG TO WIDE SLOT, FULLY INSERT.

This Class B digital apparatus complies with Canadian ICES-003.

Only for C models.

ATTENTION

POUR PREVENIR TOUTE DECHARGE ELECTRIQUE, INSEREZ COMPLETEMENT EN FAISANT COINCIDER LA LAME LARGE DE LA FICHE DANS LA FENTE LARGE.

Cet appareil numérique de la classe B est conforme à la norme NMB-003 du Canada.

Pour les modèles C uniquement.

For assistance and information
call toll free 1-800-BUY-AIWA
(United States and Puerto Rico)

AIWA CO.,LTD.
 <http://www.aiwa.co.jp>